

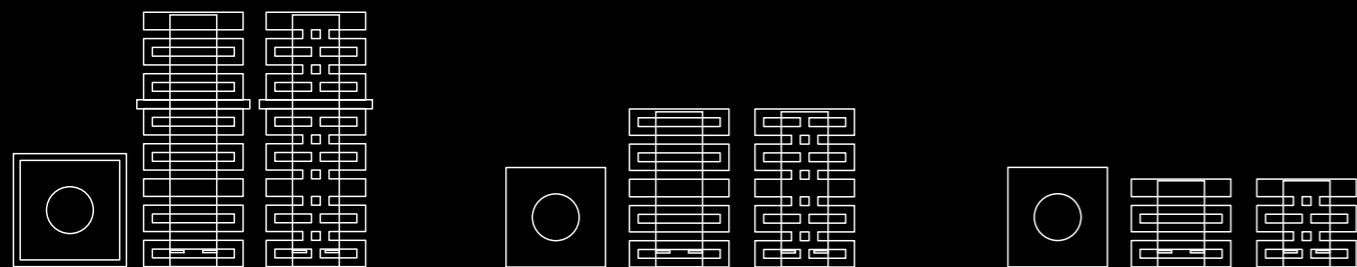

ZIKUR



Item	AxB	Height	
BSZ-44-S	170x170	440	no light
BSZ-44-SL	170x170	440	incl.LED

Item	AxB	Height	
BSZ-27-S	170x170	270	no light
BSZ-27-SL	170x170	270	incl.LED

Item	AxB	Height	
BSZ-15-S	170x170	150	no light

GLASS BOARDS

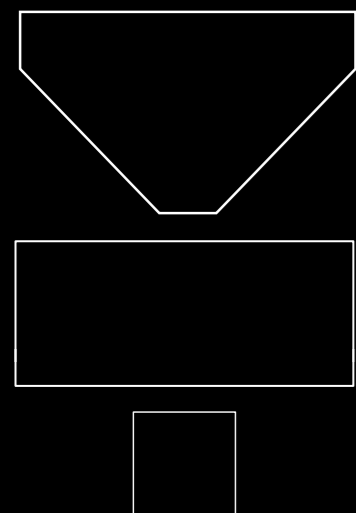

Item	AxB	Thickness
GT-1000/250x600-AA	1000x600	6

Item	AxB	Thickness
GR-1000x400-AA	1000x400	6

Item	AxB	Thickness
GR-300x300-AA	300x300	6

notice: details to following displayed items: S4-801-01/w, S4-602-65, P16-52-01, P16-55-01, S10-37-01, T4-49-65, P16-58-01, K9-53-01, O12-47-65 you will find in our general catalogue
 details to following displayed items: O12-311-28 and O12-312-28 you can find in this brochure

ORION

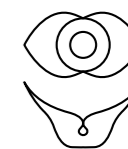

Item	AxB	Height	Thickness
O12-311-AA	115x70	63	3 or 4
O12-312-AA	85x65	52	3 or 4



GEMA

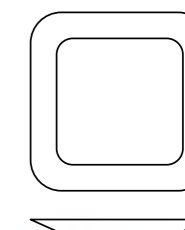

Item	AxB	Height	Thickness
G10-42-AA	300x300	21	4
G10-43-AA	240x240	19	4
G10-46-AA	190x190	18	4
G10-47-AA	150x150	17	4



Item	AxB	Height	Thickness
G10-44-AA	400x220	21	4
G10-45-AA	300x155	20	4

Item	AxB	Height	Thickness
G10-462-AA	210x210	37	4

Item	AxB	Height	Thickness
G10-422-AA	270x270	40	4
G10-472-AA	170x170	51	4





GLASS BOARDS



Item
GR-1000x400-AA

AxB
1000x400

Thickness
6

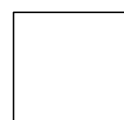

Item
GR-300x300-AA

AxB
300x300

Thickness
6

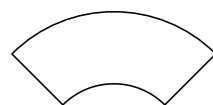

Item
GC-R400/R200/90-AA

AxB
r400/r200/90

Thickness
6

notice: details to following displayed items: S4-831-49, S4-832-61, O12-38-01, C2-501-49, O12-40-65, O12-309-03, O12-309-61, B4-42-D23, D9-61-65, O12-305-31/P, O12-35-01, X3-62-65 you will find in our general catalogue
details to following displayed items: O12-311-31, O12-312-01, O12-412-65, C2-50-D29, C2-503-D28, C2-501-50/L you can find in this brochure

PLEXI

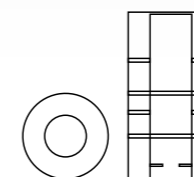

Item	AxB	Height	
BSP-40-CSL	d200	400	clear, includ.LED
BSP-40-CS	d200	400	clear, no light
BSP-40-MSL	d200	400	matt, includ. LED
BSP-40-MS	d200	400	matt, no light

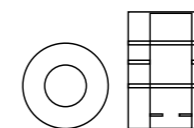

Item	AxB	Height	
BSP-28-CSL	d200	280	clear, includ.LED
BSP-28-CS	d200	280	clear, no light
BSP-28-MSL	d200	280	matt, includ. LED
BSP-28-MS	d200	280	matt, no light

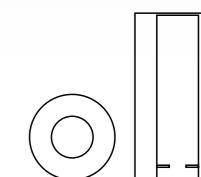

Item	AxB	Height	
BSP-40-CL	d200	400	clear, includ.LED
BSP-40-C	d200	400	clear, no light
BSP-40-ML	d200	400	matt, includ. LED
BSP-40-M	d200	400	matt, no light

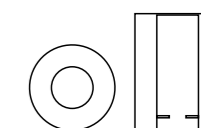

Item	AxB	Height	
BSP-28-CL	d200	280	clear, includ.LED
BSP-28-C	d200	280	clear, no light
BSP-28-ML	d200	280	matt, includ. LED
BSP-28-M	d200	280	matt, no light



Item	AxB	Height	
BSP-15-C	d200	155	clear, no light
BSP-15-M	d200	155	matt, no light

CUPOTEA

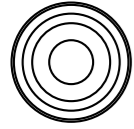

Item	AxB	Height	Thickness
C2-503-D	d125	47	4



Item	AxB	Height	Thickness
C2-50-D	d85	35	4



CUPOTEA2



Item	AxB	Height	Thickness
C2-501-AA/L	d100	49	4



TRIGON

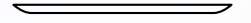
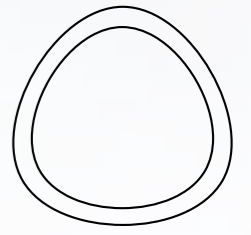

Item	AxB	Height	Thickness
T8-33-AA	270	12	3 or 4
T8-331-AA	240	12	3 or 4
T8-36-AA	200	12	3 or 4
T8-37-AA	160	12	3 or 4
T8-38-AA	120	12	3 or 4

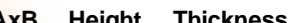
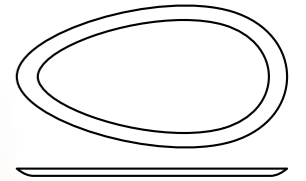

Item	AxB	Height	Thickness
T8-34-AA	400x180	12	3 or 4
T8-35-AA	300x160	12	3 or 4

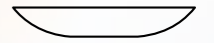
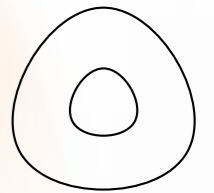

Item	AxB	Height	Thickness
T8-322-AA	270	46	3 or 4
T8-332-AA	230	39	3 or 4
T8-362-AA	200	35	3 or 4
T8-372-AA	150	27	3 or 4
T8-382-AA	100	19	3 or 4



AIRYX

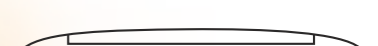
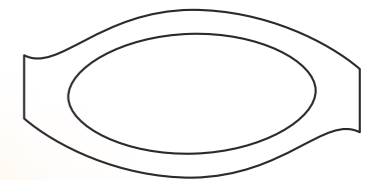

Item	AxB	Height	Thickness
A71-41-AA	540x260	33	4



EASEL

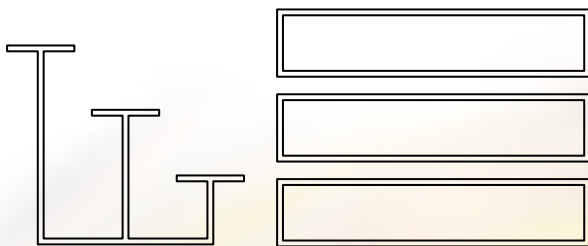

Item **AxB** **Height** **notice:** steel or black painted
 BSE-S2 535x420 340

Recommended glass items level 1:

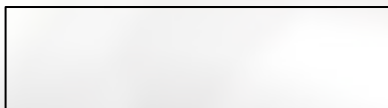

Item **AxB** **Height** **Thickness**
 GR-570x180-AA 570x180 - 6

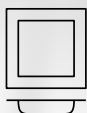

Item **AxB** **Height** **Thickness**
 G8-48-AA 140x140 30 4

Recommended glass items level 2:



Item **AxB** **Height** **Thickness**
 GR-645x180-AA 645x180 - 6



Item **AxB** **Height** **Thickness**
 X3-63-AA 615x180 12 6

Recommended glass items level 3:



Item **AxB** **Height** **Thickness**
 GR-700x180-AA 700x180 - 6

